

WING203

Automated Arm Gate System



MAG WING203 is an electro-mechanical complete system for automatic arm gate system. It is composed with primary of an electronic panel unit that control actuator motor to open or close the gate in swing motion.

Applicable for residential home with single leaf weight not exceeding 200 kg.

Features:

- Fully DC operation to avoid any potential electric hazard.
- Backup battery standby for power failure
- Actuator capability for 90° opening within only 8 to 10 second.
- Ease Installation, does not need to be installed underground.
- Remote control transmitter allow convenient operation for user in the vehicle within 30 to 50 meters from the gate

Technical Specification:

Supply Voltage	AC230V 60Hz
Backup Battery	12V 7Ah
Operating Voltage	DC 9 - 24V normal speed : DC 9 -12V Cushioning Speed
Max Length Gate	3.25 meter per wing
Safety Clutch	Electronic Current Sensing
Electronic Controller	Micro-Processor Based
Position Limit Device	Electronic Fuzzy Logic
Temperature	0 to 80°c
Arm Length	Minimum : 59 cm; Maximum: 92 cm

Package includes:

1 pair	Wing203 arm stainless steel (DC motor)
1 nos	Transformer 4amp
1 nos	PVC box
1 nos	12V 7Ah backup battery
1 set	Remote Control (3 transmitter, 1 receiver)

Typical Installation:

Swing Gate Installation Guide

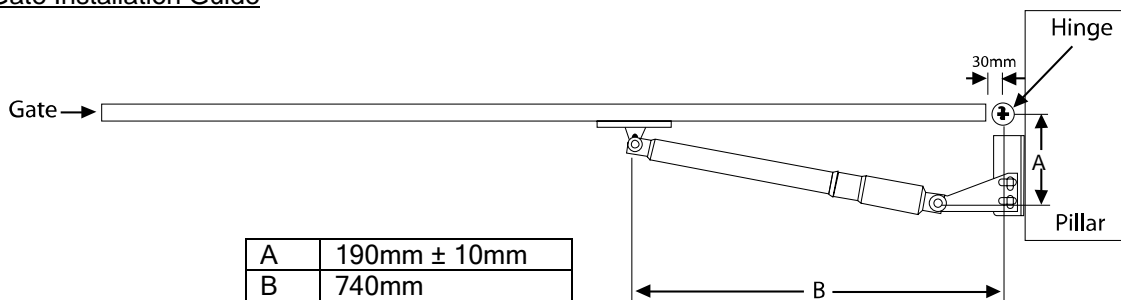

Folding Gate Installation Guide

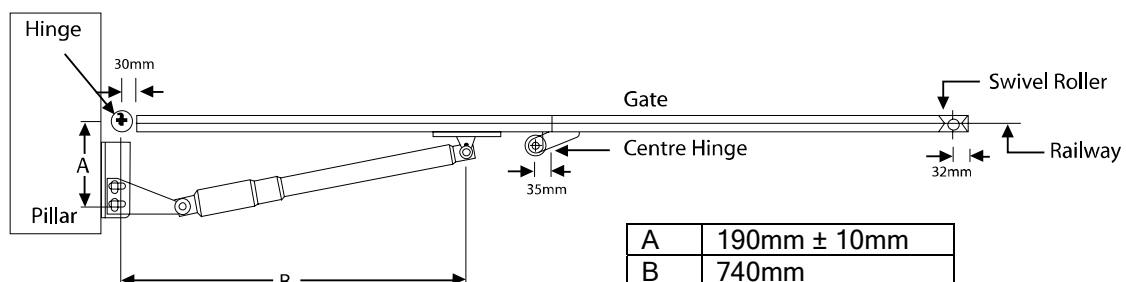

Manual Release

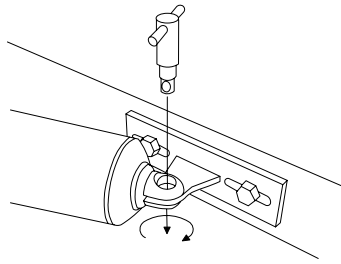

3D View

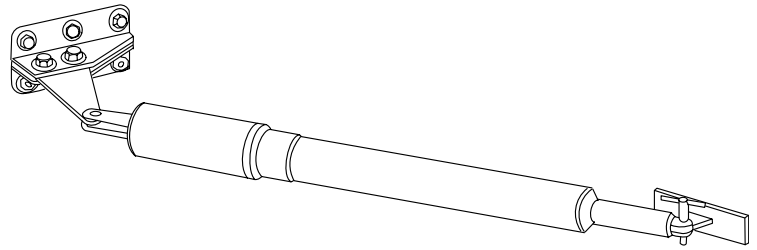

Control Panel - Model F203

The F203 control panel is specially design to match MAG Wing203 Arm Gate Motor. The system comes with a backup battery where the motor will operate in 12VDC when there is power failure. The panel requires no maintenance as long as the gate operates in right order.

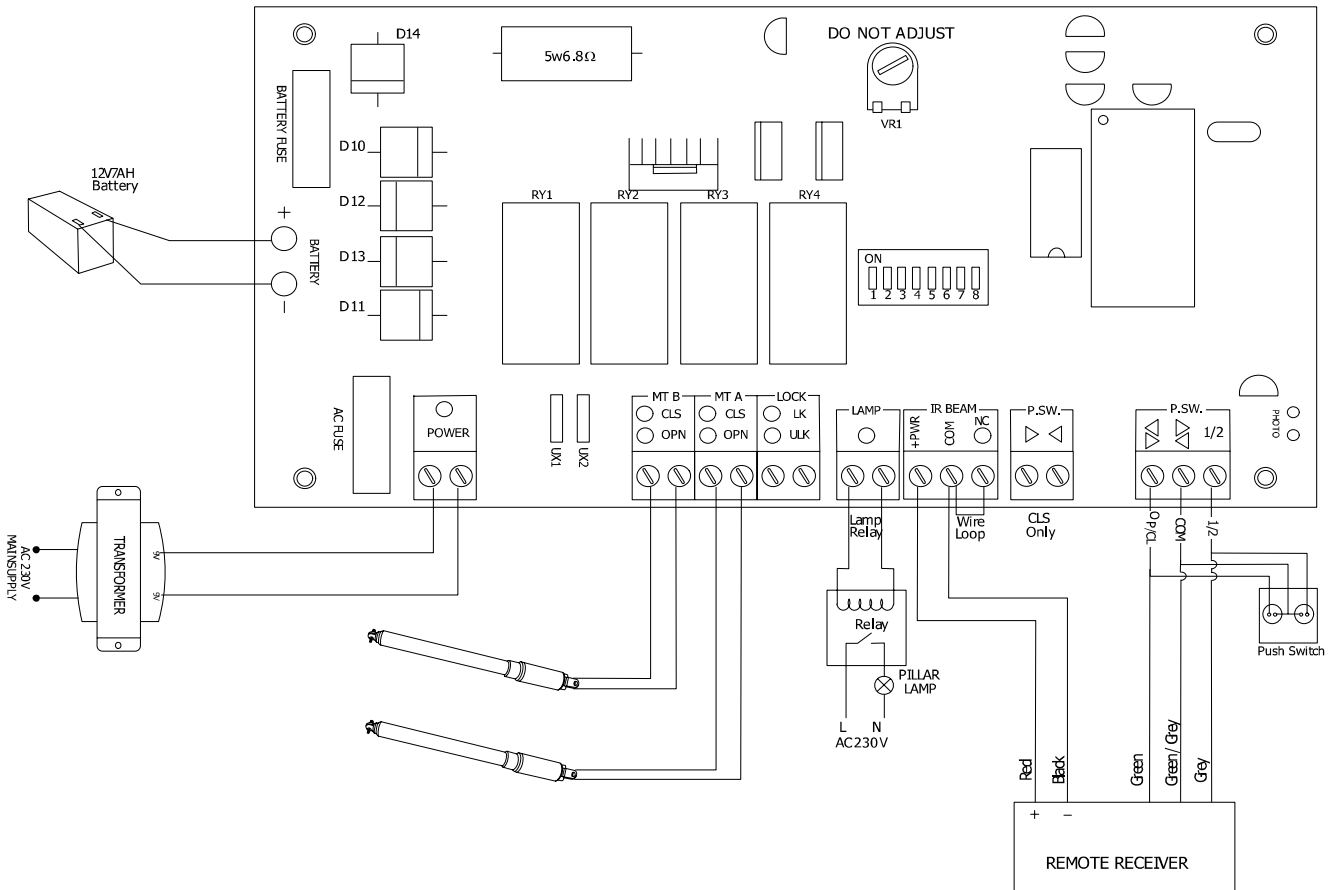

Setting the Dip Switch

The dip switch on the control panel operates as follow:

[1] ON	Delay close for motor A
[2] ON	Small reverse before opening
[3] & [4] OFF	Light relay on when gate open & cut off 1 min after gate close
[5] ON	Single gate operation only for push Switch
[6] OFF	Not in use
[7] & [8] OFF	Disable Auto Close
[7] OFF & [8] ON	30 Sec. Auto Close
[7] ON & [8] OFF	60 Sec. Auto Close
[7] ON & [8] ON	120 Sec. Auto Close

Calibrating the system

1. Unplug all power and make sure both gate completely closed.
2. Supply power to the system and press transmitter (Button 2) and let the motor open (low speed) until the end. Both the motor will stop automatically when the system detect high amp.
3. Press transmitter (button 2) again and let the motor close (high speed) until the end as it will stop when high amp.
4. The system is now fully calibrated and ready to be used
5. The gate will auto reverse when the system detects high amp during operation.

© COPYRIGHT Sept 2008. This documentation served as a reference only. It is subject to change without further notice. All the diagrams and information in this documentation may not be duplicated or modified in any form without the written approval from the management.